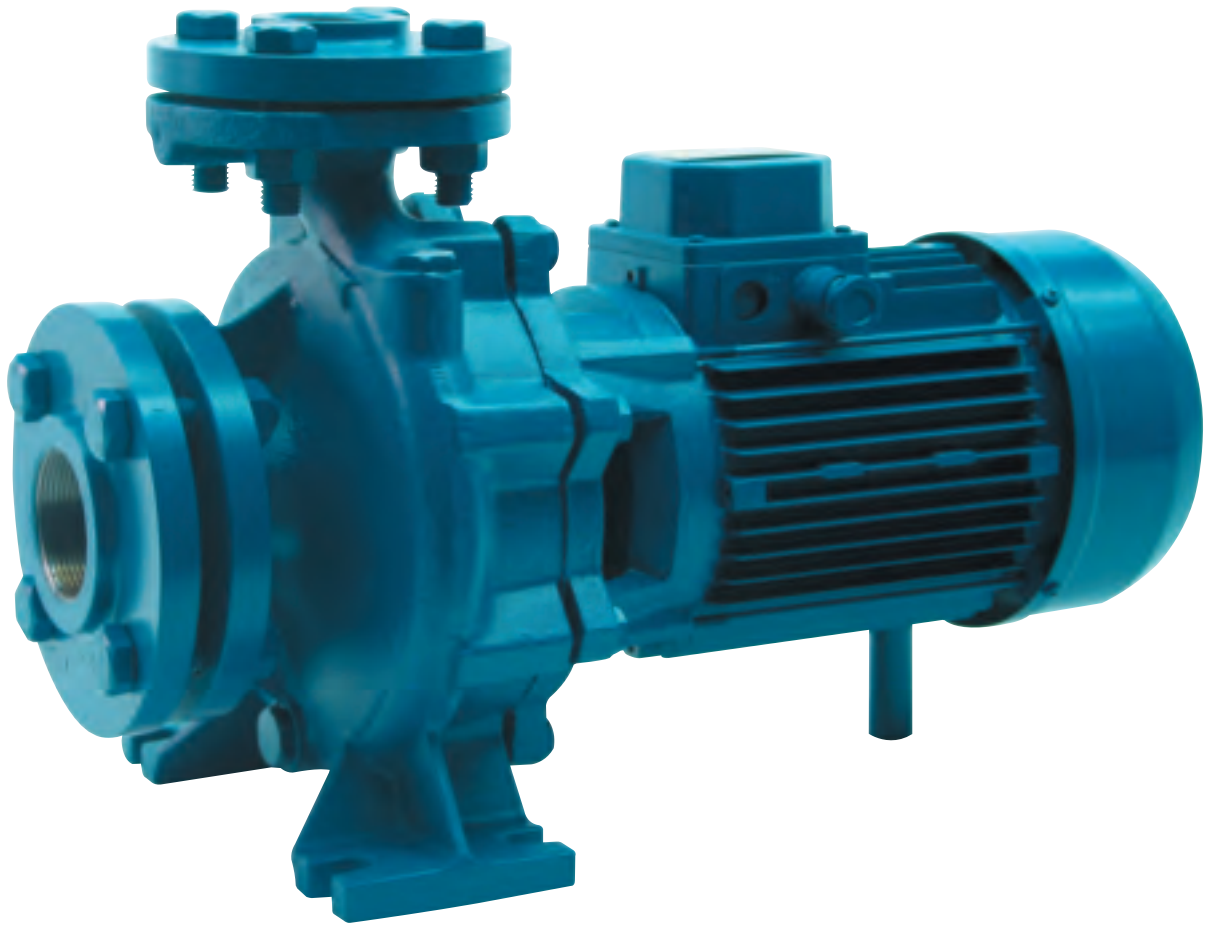

# CM RANGE

**E**

### **CENTRIFUGAL PUMPS IN CONFORMANCE WITH DIN 24255 FOR USE IN THE CIVIL, AGRICULTURAL AND INDUSTRIAL FIELDS**

The CM series is made up of single stage electric monobloc pumps with a flanged hydraulic/motor connection. The pump casing is manufactured in accordance with the provisions of DIN 24255-NF E 44 III-UNI 7467 standards, regarding hydraulic dimensions and connection points. The pumps may be installed in all positions, except where the suction point is directed downwards. The design of these machines allows the rotating parts and the motor to be removed from the pump casing without having to disconnect the pipes. Thus any maintenance is easily and quickly performed.

#### **Standard Design Features:**

Cast iron pump casing, motor bracket and impeller. Stainless steel shaft. Mechanical seal with ceramic/graphite counterfaces. Flanged connection points DN32 – DN80 2236 PN10 standards. Threaded type counter flanges UNI 2254.

Clean water pumping only, non aggressive, non explosive and free from abrasives and fibres. Liquid temperature from  $-10^{\circ}\text{C}$  to  $90^{\circ}\text{C}$ . Environmental temperature up to  $40^{\circ}\text{C}$  max. Maximum operating pressure 10 bar.

#### **Applications include:**

Irrigation supply, heating and air conditioning systems, water supply, liquid transfer and fire fighting systems.

# SURFACE MOUNTED PUMPS

## CM DIN 24255

Dimensions (mm)				
DN	D	K	Holes	
			n°	Dia.
32	140	100	4	18
40	150	110	4	18
50	165	125	4	18
65	185	145	4	18
80	200	160	4	18
100	220	180	8	18

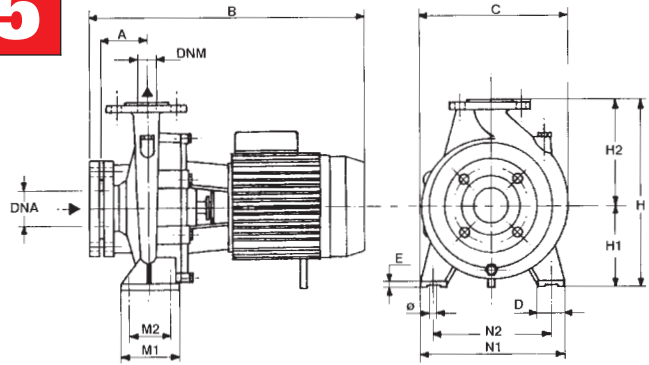

Model	Dimensions (mm)															Weight kg
	DNM	DNA	A	H <sub>1</sub>	H <sub>2</sub>	M <sub>1</sub>	M <sub>2</sub>	N <sub>1</sub>	N <sub>2</sub>	D	E	Ø	B	C	H	
CM 32/160	32	50	80	132	160	100	70	240	190	50	12	14	490	240	292	38
																39
																42
CM 32/200	32	50	80	160	180	100	70	240	190	50	12	14	505	268	340	52
													63			
													69			
CM 32/250	32	50	100	180	225	125	95	320	250	65	14	14	625	305	405	83
													90			
													120			
CM 40/125	40	65	80	112	140	100	70	210	160	50	12	14	495	220	252	36
																37
																40
CM 40/160	40	65	80	132	160	100	70	240	190	50	12	14	500	245	292	47
													50			
													65			
CM 40/200	40	65	100	160	180	100	70	265	212	50	15	15	590	273	340	71
													71			
													91			
CM 40/250	40	65	100	180	225	125	95	320	250	65	15	15	630	322	405	91
													121			
													121			
CM 50/125	50	65	100	132	160	100	70	240	190	50	12	14	525	250	292	47
																50
																50
CM 50/160	50	65	100	150	180	100	70	265	212	50	12	14	590	270	340	65
													71			
													82			
CM 50/200	50	65	100	160	200	100	70	265	212	50	12	14	635	290	360	89
													122			
													125			
CM 50/250	50	65	100	180	225	125	95	320	250	65	14	14	705	332	405	140
													149			
													149			
CM 65/125	65	80	100	160	180	125	95	280	212	65	14	14	605	280	340	64
													70			
													70			
CM 65/160	65	80	100	160	200	125	95	280	212	65	14	14	635	290	360	84
													90			
													120			
CM 65/200	65	80	100	180	225	125	95	320	250	65	14	14	705	330	405	122
													138			
													148			
CM 65/250	65	80	100	200	250	160	120	360	280	80	16	19	750	370	450	239
													253			
													253			
CM 80/160	80	100	125	180	225	125	95	320	250	65	14	14	665	330	405	99
													129			
													143			
CM 80/200	80	100	125	180	225	125	95	345	280	65	16	14	780	330	405	152
													233			
													247			

**CM 32**

**E**

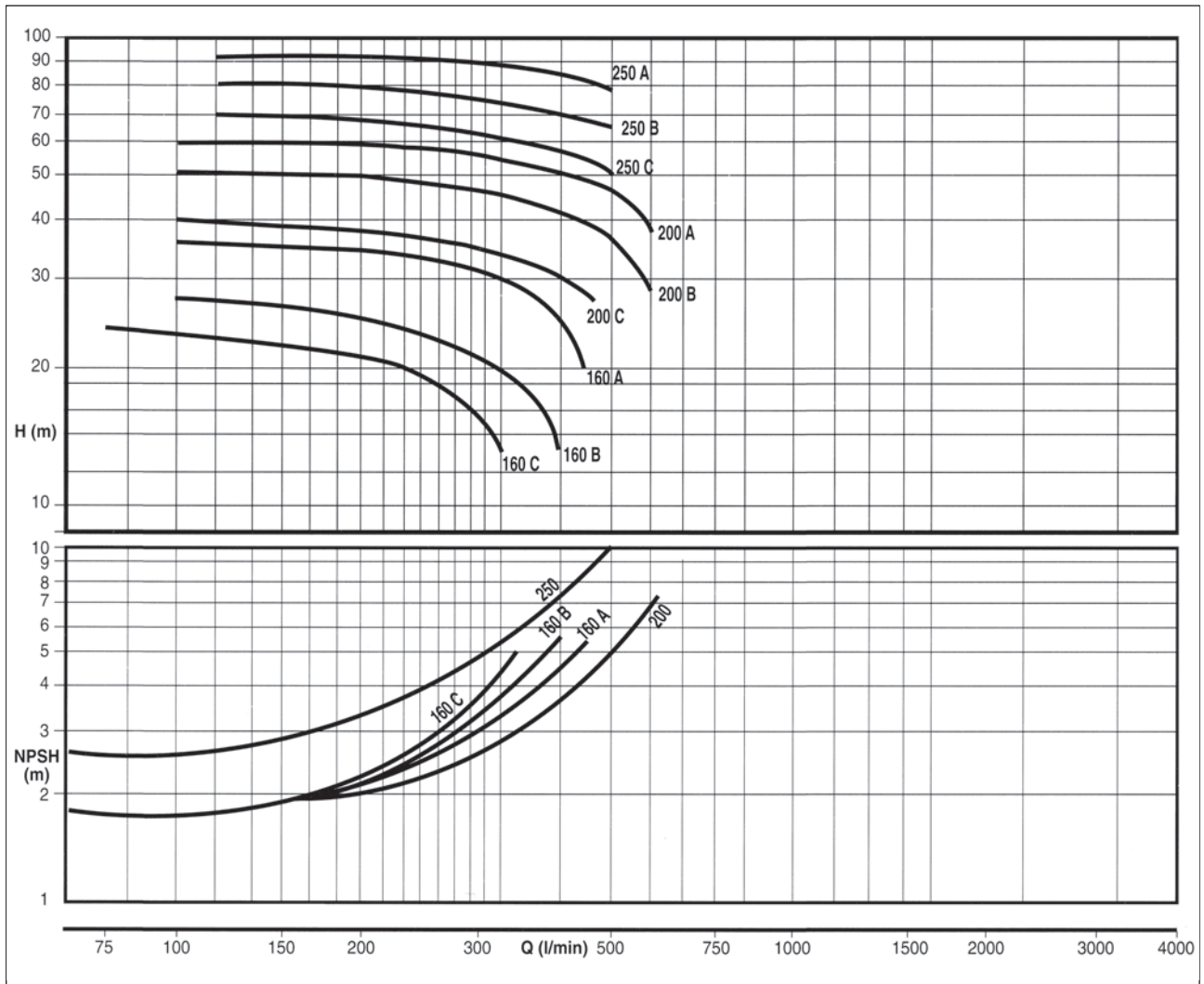

MODEL	Motor Power		VOLTAGE	Amp. 3 x 400 V	CODE	PRICE
	HP	KW				
CM 32/160 C	2	1,5	3 ~ 230 ÷ 400 V	4	573-2KKK	
CM 32/160 B	3	2,2	3 ~ 230 ÷ 400 V	5,2	573-3KKK	
CM 32/160 A	4	3	3 ~ 230 ÷ 400 V	7,1	573-4KKK	
CM 32/200 C	5,5	4	3 ~ 230 ÷ 400 V	9,4	573-5KKK	
CM 32/200 B	7,5	5,5	3 ~ 400 ÷ 690 V	14,2	573-7KKK	
CM 32/200 A	10	7,5	3 ~ 400 ÷ 690 V	16,5	573-9KKK	
CM 32/250 C	12,5	9,2	3 ~ 400 ÷ 690 V	20,1	574-0KKK	
CM 32/250 B	15	11	3 ~ 400 ÷ 690 V	24,2	574-1KKK	
CM 32/250 A	20	15	3 ~ 400 ÷ 690 V	30,1	574-2KKK	

# CM 40

**E**

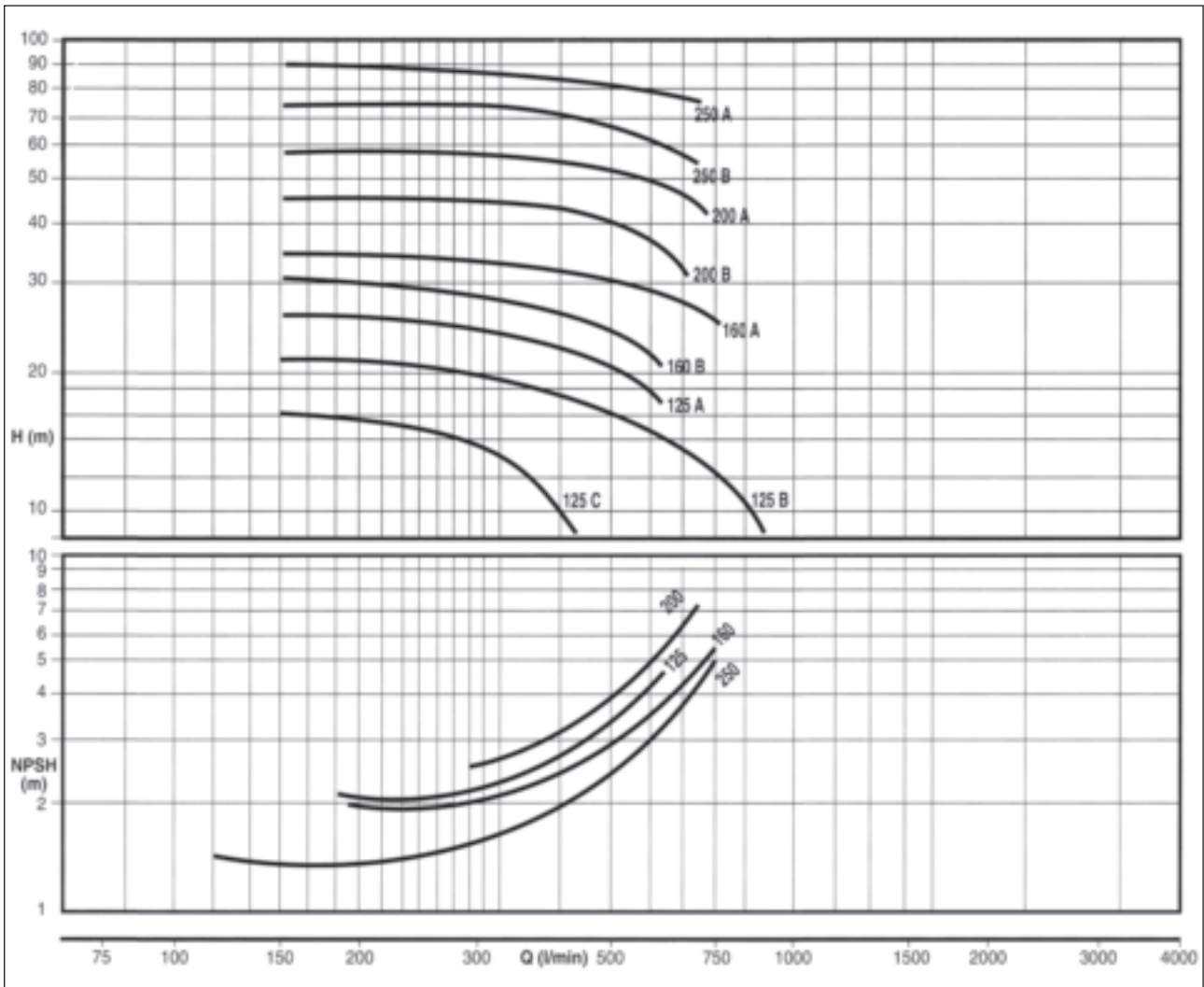

MODEL	Motor Power		VOLTAGE	Amp. 3 x 400 V	CODE	PRICE
	HP	KW				
CM 40/125 C	2	1,5	3 ~ 230 ÷ 400 V	4	577-0KKK	
CM 40/125 B	3	2,2	3 ~ 230 ÷ 400 V	5,2	577-1KKK	
CM 40/125 A	4	3	3 ~ 230 ÷ 400 V	7,1	577-2KKK	
CM 40/160 B	4	3	3 ~ 230 ÷ 400 V	7,4	574-4KKK	
CM 40/160 A	5,5	4	3 ~ 230 ÷ 400 V	9,9	574-5KKK	
CM 40/200 B	7,5	5,5	3 ~ 400 ÷ 690 V	13,2	574-6KKK	
CM 40/200 A	10	7,5	3 ~ 400 ÷ 690 V	16,8	575-1KKK	
CM 40/250 B	15	11	3 ~ 400 ÷ 690 V	24,2	574-9KKK	
CM 40/250 A	20	15	3 ~ 400 ÷ 690 V	32	575-0KKK	

# CM 50

**E**

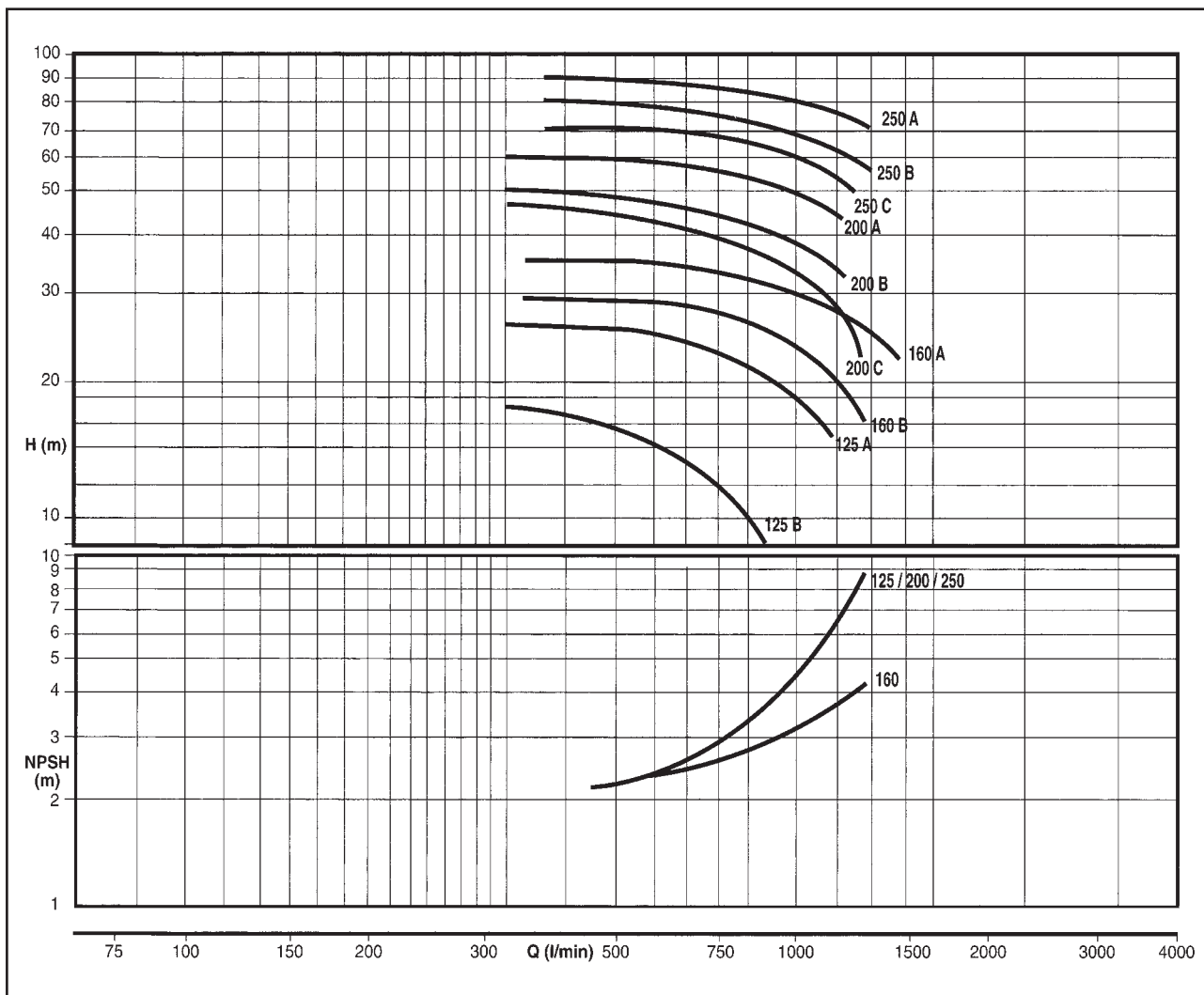

MODEL	Motor Power		VOLTAGE	Amp. 3 x 400 V	CODE	PRICE
	HP	KW				
CM 50/125 B	4	3	3 ~ 230 ÷ 400 V	7,4	577-3KKK	
CM 50/125 A	5,5	4	3 ~ 230 ÷ 400 V	9,9	577-4KKK	
CM 50/160 B	7,5	5,5	3 ~ 400 ÷ 690 V	11,6	575-3KKK	
CM 50/160 A	10	7,5	3 ~ 400 ÷ 690 V	15,8	575-5KKK	
CM 50/200 C	12,5	9,2	3 ~ 400 ÷ 690 V	18,5	577-5KKK	
CM 50/200 B	15	11	3 ~ 400 ÷ 690 V	21	575-6KKK	
CM 50/200 A	20	15	3 ~ 400 ÷ 690 V	27	575-7KKK	
CM 50/250 C	20	15	3 ~ 400 ÷ 690 V	32,5	575-8KKK	
CM 50/250 B	25	18,5	3 ~ 400 ÷ 690 V	41,5	575-9KKK	
CM 50/250 A	30	22	3 ~ 400 ÷ 690 V	51,5	576-0KKK	

## CM 65

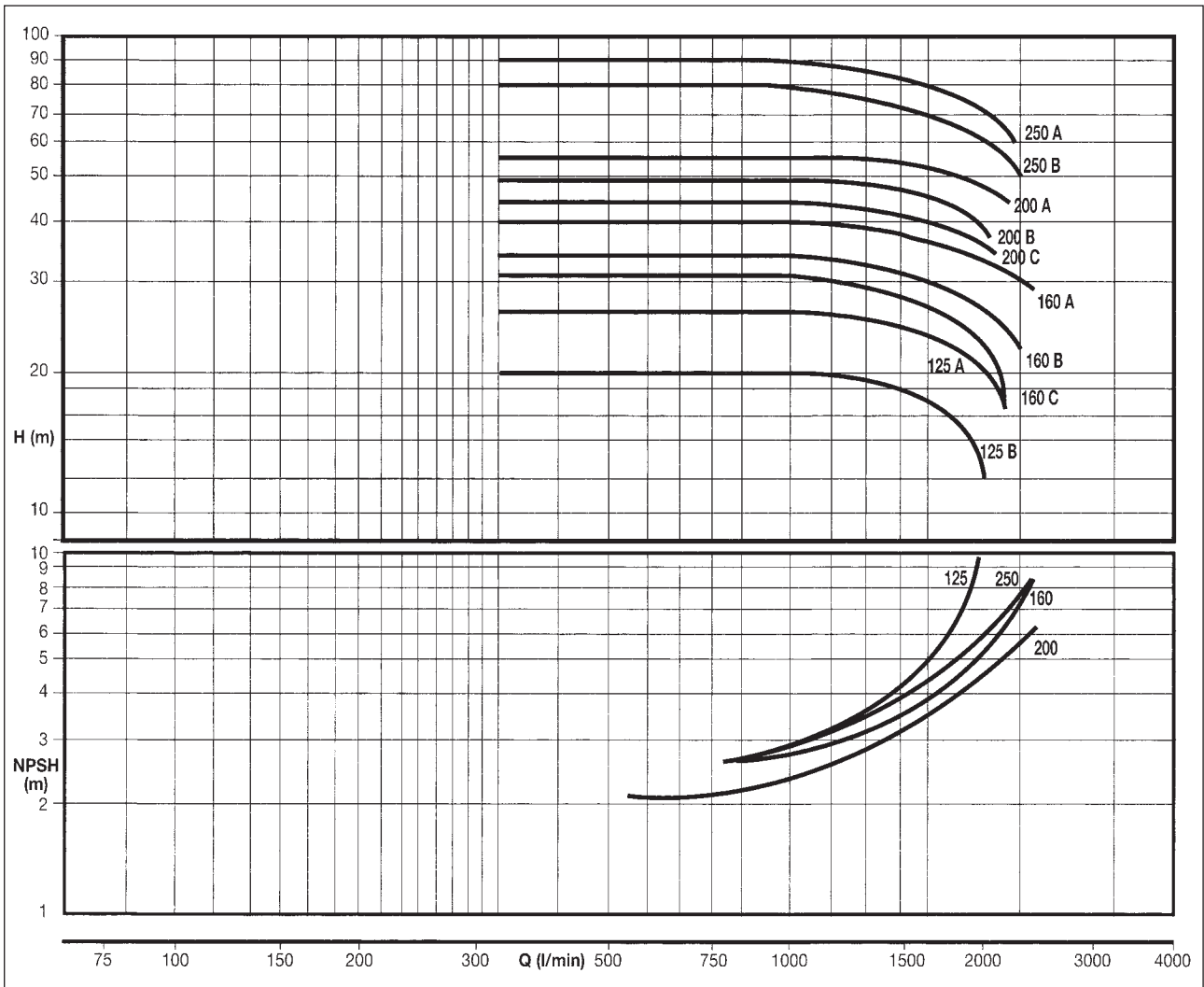
**E**

MODEL	Motor Power		VOLTAGE	Amp. 3 x 400 V	CODE	PRICE
	HP	KW				
CM 65/125 B	7,5	5,5	3 ~ 400 ÷ 690 V	12,3	577-6KKK	
CM 65/125 A	10	7,5	3 ~ 400 ÷ 690 V	15,9	577-7KKK	
CM 65/160 C	12,5	9	3 ~ 400 ÷ 690 V	19,5	576-1KKK	
CM 65/160 B	15	11	3 ~ 400 ÷ 690 V	22,5	576-2KKK	
CM 65/160 A	20	15	3 ~ 400 ÷ 690 V	30	576-3KKK	
CM 65/200 C	20	15	3 ~ 400 ÷ 690 V	32,5	576-4KKK	
CM 65/200 B	25	18,5	3 ~ 400 ÷ 690 V	41,5	576-5KKK	
CM 65/200 A	30	22	3 ~ 400 ÷ 690 V	51,5	576-6KKK	
CM 65/250 B	40	30	3 ~ 400 ÷ 690 V	63,5	577-8KKK	
CM 65/250 A	50	37	3 ~ 400 ÷ 690 V	74,5	577-9KKK	

# CM 80

**E**

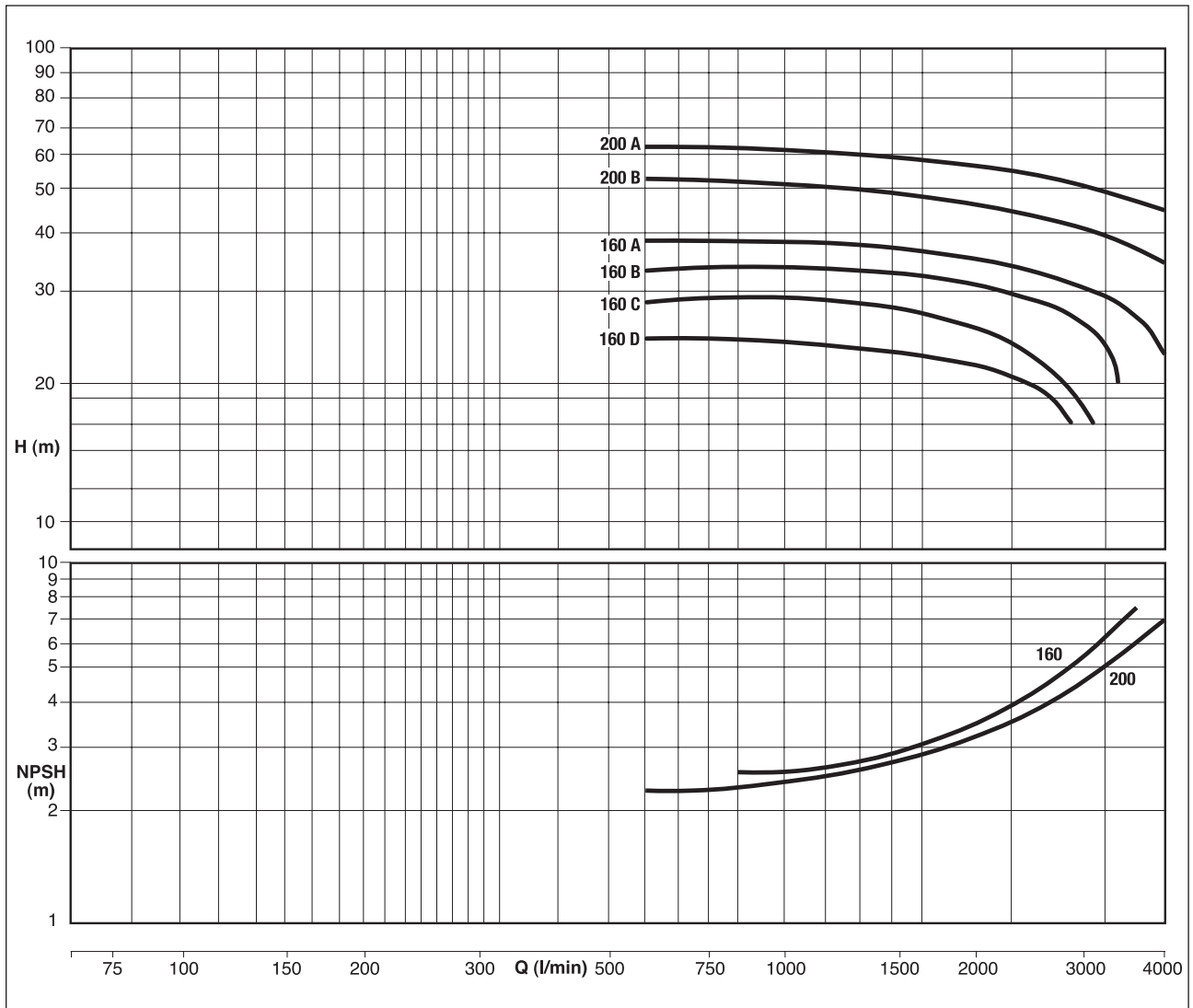

MODEL	Motor Power		VOLTAGE	Amp. 3 x 400 V	CODE	PRICE
	HP	KW				
CM 80/160 D	15	11	3 ~ 400 ÷ 690 V	20,8	578-0KKK	
CM 80/160 C	20	15	3 ~ 400 ÷ 690 V	25,8	578-1KKK	
CM 80/160 B	25	18,5	3 ~ 400 ÷ 690 V	35	578-2KKK	
CM 80/160 A	30	22	3 ~ 400 ÷ 690 V	42	578-3KKK	
CM 80/200 B	40	30	3 ~ 400 ÷ 690 V	63,5	578-6KKK	
CM 80/200 A	50	37	3 ~ 400 ÷ 690 V	74,5	578-7KKK	

**BOOSTER SETS**



CM PUMPS ARE AVAILABLE AS BOOSTER SETS



VLR TWIN BOOSTER SETS, SEE PAGE 72-73



PRESSOMAT TWIN BOOSTER SETS, SEE PAGE 70-71



VSD VARIABLE SPEED BOOSTERS, SEE PAGES 75-79

## VERTICAL MULTISTAGE CENTRIFUGAL PUMPS

E

The VLR 2B's are vertical multistage centrifugal pumps with "in line" suction and delivery points directly connected to an electric motor. They are not self-priming.

### Design Features include:

Impellers, diffusers and outer pump chamber in AISI 304 stainless steel, shaft in AISI 316 stainless steel. Base and head casting are cast iron. Tungsten carbide mechanical seal. EPDM o rings. All 'A' versions are complete with 1" oval counterflanges. All 'F' versions are DN32 round flanges, counterflanges are available upon request.

Liquid temperatures range from -15°C to +120°C

Maximum operating pressures:

DIN flanges 25 bar (maximum pumped liquid temperature 40°C)

21 bar (maximum pumped liquid temperature 120°C)

Maximum inlet pressures:

VLR2B-30/2 = 6 Bar

VLR 2B-30 - VLR 2B-110 = 10 Bar

VLR 2B-130 - VLR 2B-260 = 15 Bar

### Applications include:

Water supply, pressure boosting systems, irrigation, high pressure washers, fire fighting systems, boiler supply and liquid transfers.

The VLR range is also available with stainless steel AISI 304 base - VLRI range.

The VLR range is also available made with AISI 316 stainless steel impellers, diffusers, shaft, outer liner and base - VLRX range.

Please contact our sales representatives for further information.



MODEL	Motor Power		VOLTAGE	Amp.	µF.	CODE	PRICE
	HP	KW					
VLR 2B - 30/2 A M	0,5	0,37	1 ~ 230 V	2,7	14	230-2102	
VLR 2B - 30/2 A T			3 ~ 230 ÷ 400 V	1-0,6		230-1002	
VLR 2B - 30 A M	0,5	0,37	1 ~ 230 V	2,7	14	230-2103	
VLR 2B - 30 A T			3 ~ 230 ÷ 400 V	1,4-0,8		230-1003	
VLR 2B - 40 A M	0,75	0,55	1 ~ 230 V	4	16	230-2104	
VLR 2B - 40 A T			3 ~ 230 ÷ 400 V	1,8-1		230-1004	
VLR 2B - 50 A M	0,75	0,55	1 ~ 230 V	4	16	230-2105	
VLR 2B - 50 A T			3 ~ 230 ÷ 400 V	2,3-1,3		230-1005	
VLR 2B - 60 A M	1	0,75	1 ~ 230 V	5,2	25	230-2106	
VLR 2B - 60 A T			3 ~ 230 ÷ 400 V	2,7-1,5		230-1006	
VLR 2B - 70 A M	1	0,75	1 ~ 230 V	5,2	25	230-2107	
VLR 2B - 70 A T			3 ~ 230 ÷ 400 V	3-1,7		230-1007	
VLR 2B - 90 A M	1,5	1,1	1 ~ 230 V	8	35	230-2109	
VLR 2B - 90 A T			3 ~ 230 ÷ 400 V	3,6-2,1		230-1009	
VLR 2B - 110 A M	1,5	1,1	1 ~ 230 V	8	35	230-2111	
VLR 2B - 110 A T			3 ~ 230 ÷ 400 V	4,3-2,5		230-1011	
VLR 2B - 130 A M	2	1,5	1 ~ 230 V	12	45	230-2113	
VLR 2B - 130 A T			3 ~ 230 ÷ 400 V	5-2,9		230-1013	
VLR 2B - 150 A M	2	1,5	1 ~ 230 V	12	45	230-2115	
VLR 2B - 150 A T			3 ~ 230 ÷ 400 V	5,7-3,3		230-1015	
VLR 2B - 180 F T	3	2,2	3 ~ 230 ÷ 400 V	7,2-4,1		233-1018	
VLR 2B - 220 F T	3	2,2	3 ~ 230 ÷ 400 V	8,6-5		233-1022	
VLR 2B - 260 F T	4	3	3 ~ 230 ÷ 400 V	11,4-6,6		233-1026	

## VLR 2B

- 1 Version with oval flanges  
VLR 2B 30/2 - VLR 2B 150

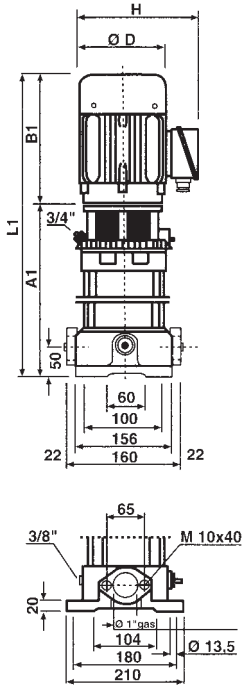

- 2 Version with round flanges  
PN10 DIN 2534/ISO 7005-2

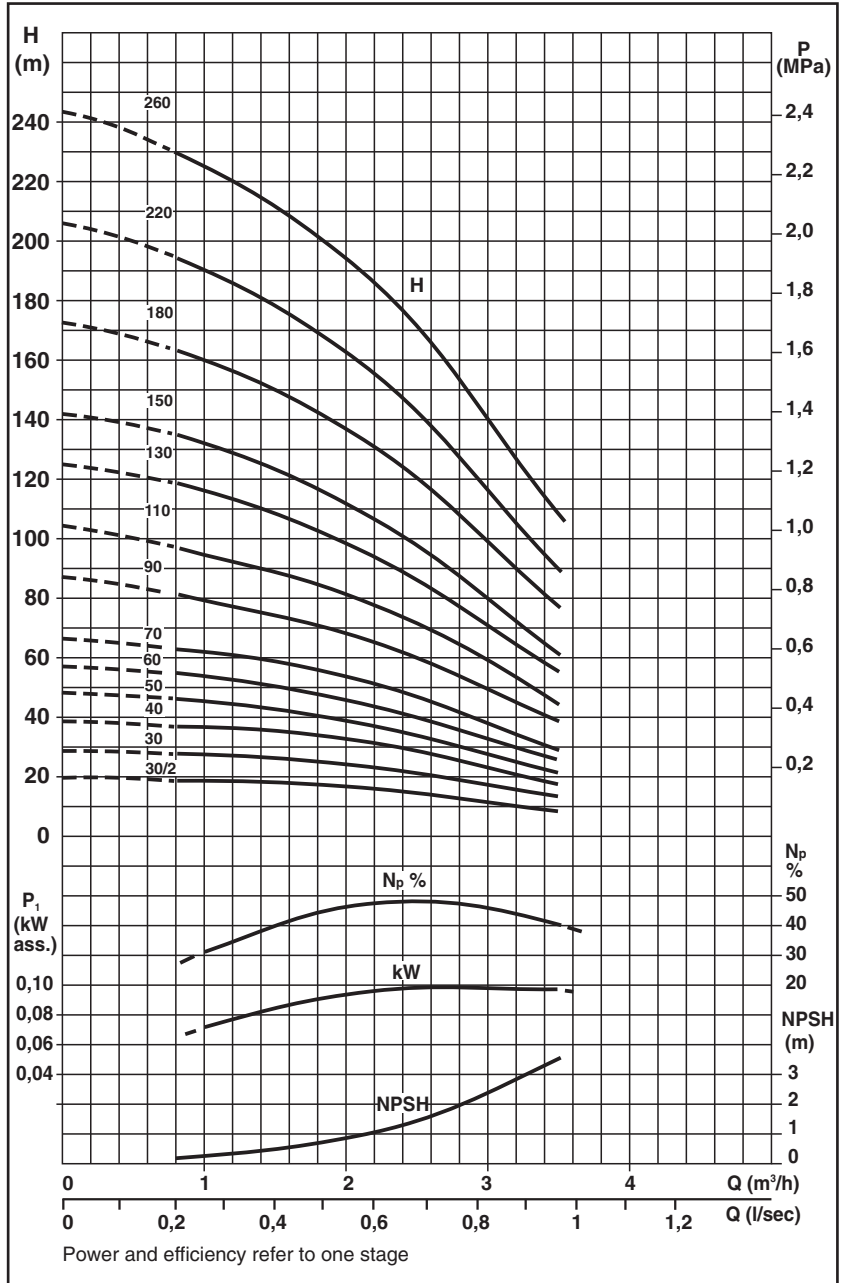
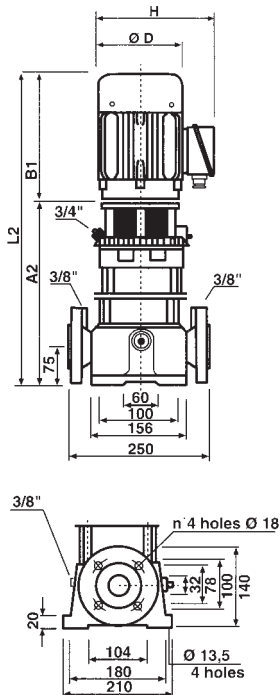

Model	Dimensions (mm)						Net Weight (kg)		
	A <sub>1</sub> ①	B <sub>1</sub>	L <sub>1</sub> ①	A <sub>2</sub> ①	L <sub>2</sub> ②	D	H		
VLR 2B - 30/2	238	213	451	-	-	142	109	20	-
VLR 2B - 30	238	213	451	-	-	142	109	21	-
VLR 2B - 40	256	213	469	-	-	142	109	23	-
VLR 2B - 50	274	213	487	-	-	142	109	25	-
VLR 2B - 60	296	237	533	-	-	160	131	26	-
VLR 2B - 70	314	237	551	-	-	160	131	33	-
VLR 2B - 90	350	237	587	-	-	160	131	34	-
VLR 2B - 110	386	237	623	-	-	160	131	36	-
VLR 2B - 130	441	265	706	-	-	185	130	37	-
VLR 2B - 150	477	265	742	-	-	185	130	43	-
VLR 2B - 180	-	265	-	556	821	185	130	-	49
VLR 2B - 220	-	265	-	628	893	185	130	-	61
VLR 2B - 260	-	315	-	704	1019	200	140	-	63

## VERTICAL MULTISTAGE CENTRIFUGAL PUMPS

**E**

The VLR 4's are vertical multistage centrifugal pumps with "in line" suction and delivery points directly connected to an electric motor. They are not self-priming.

### Design Features include:

Impellers, diffusers and outer pump chamber in AISI 304 stainless steel, shaft in AISI 316 stainless steel. Base and head casting are cast iron. Tungsten carbide mechanical seal. EPDM o rings. All 'A' versions are complete with 1 1/4" oval counterflanges. All 'F' versions are DN32 round flanges, counterflanges are available upon request.

Liquid temperatures range from -15°C to +120°C

Maximum operating pressures:

DIN flanges 25 bar (maximum pumped liquid temperature 40°C)

21 bar (maximum pumped liquid temperature 120°C)

Maximum inlet pressures:

VLR 4-20 = 6 Bar

VLR 4-30 - VLR 4-100 = 10 Bar

VLR 4-120 - VLR 4-260 = 15 Bar

### Applications include:

Water supply, pressure increase systems, irrigation, high pressure washers, fire fighting systems, boiler supply and liquid transfers.

The VLR range is also available with stainless steel AISI 304 base - VLRI range.

The VLR range is also available made with AISI 316 stainless steel impellers, diffusers, shaft, outer liner and base - VLRX range.

Please contact our sales representatives for further information.



MODEL	Motor Power		VOLTAGE	Amp.	µF.	CODE	PRICE
	HP	KW					
VLR 4 - 20 A M	0,5	0,37	1 ~ 230 V	2,7	14	350-2102	
VLR 4 - 20 A T			3 ~ 230 ÷ 400 V	1,73-1		350-1002	
VLR 4 - 30 A M	0,75	0,55	1 ~ 230 V	4	16	350-2103	
VLR 4 - 30 A T			3 ~ 230 ÷ 400 V	2,5-1,45		350-1003	
VLR 4 - 40 A M	1	0,75	1 ~ 230 V	5,2	25	350-2104	
VLR 4 - 40 A T			3 ~ 230 ÷ 400 V	3,3-1,9		350-1004	
VLR 4 - 50 A M	1,5	1,1	1 ~ 230 V	8	35	350-2105	
VLR 4 - 50 A T			3 ~ 230 ÷ 400 V	4,3-2,5		350-1005	
VLR 4 - 60 A M	1,5	1,1	1 ~ 230 V	8	35	350-2106	
VLR 4 - 60 A T			3 ~ 230 ÷ 400 V	4,3-2,5		350-1006	
VLR 4 - 80/7 A M	2	1,5	1 ~ 230 V	12	45	350-2107	
VLR 4 - 80/7 A T			3 ~ 230 ÷ 400 V	5,9-3,4		350-1007	
VLR 4 - 80 A M	2	1,5	1 ~ 230 V	12	45	350-2108	
VLR 4 - 80 A T			3 ~ 230 ÷ 400 V	5,9-3,4		350-1008	
VLR 4 - 100 A T	3	2,2	3 ~ 230 ÷ 400 V	8,3-4,8		350-1010	
VLR 4 - 120 A T	3	2,2	3 ~ 230 ÷ 400 V	8,3-4,8		350-1012	
VLR 4 - 140 A T	4	3	3 ~ 230 ÷ 400 V	10,9-6,3		350-1014	
VLR 4 - 160 A T	4	3	3 ~ 230 ÷ 400 V	10,9-6,3		350-1016	
VLR 4 - 190 F T	5,5	4	3 ~ 400 ÷ 690 V	13,8-8		353-1119	
VLR 4 - 220 F T	5,5	4	3 ~ 400 ÷ 690 V	13,8-8		353-1122	
VLR 4 - 240 F T	7,5	5,5	3 ~ 400 ÷ 690 V	12,4-21,5		353-1124	
VLR 4 - 260 F T	7,5	5,5	3 ~ 400 ÷ 690 V	12,4-21,5		353-1126	

## VLR 4

- 1 Version with oval flanges  
VLR 4-20 - VLR 4-160

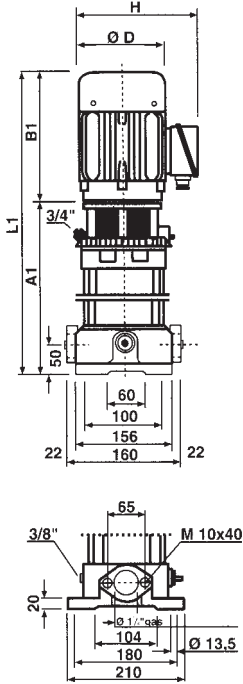

- 2 Version with round flanges  
PN10 DIN 2534/ISO 7005-2

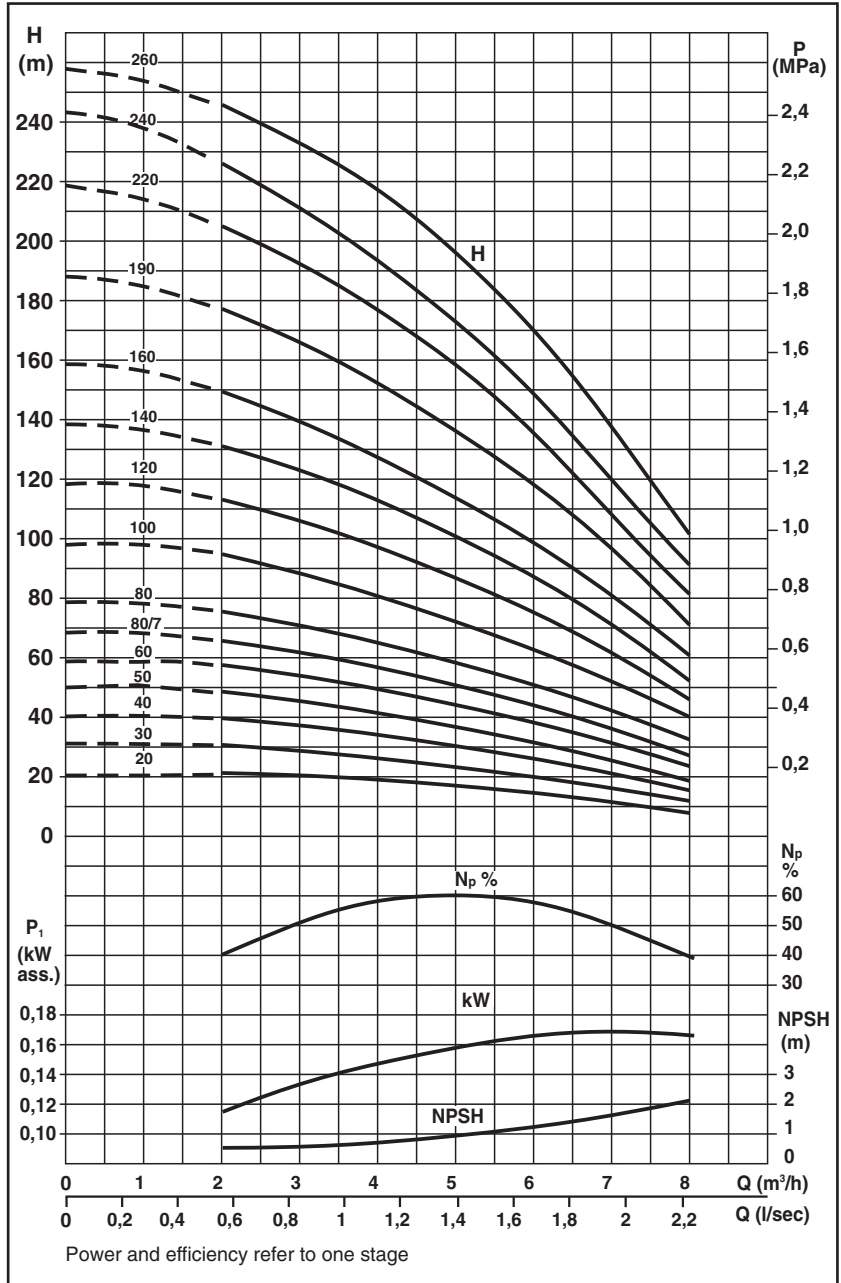
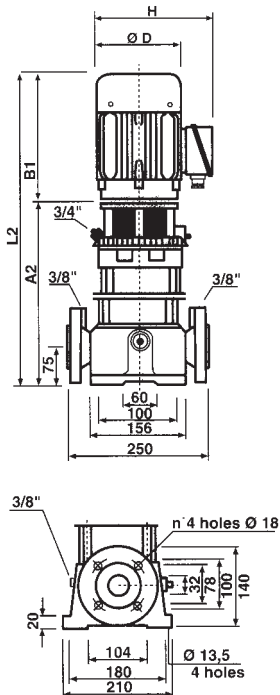

Model	Dimensions (mm)						Net Weight (kg)		
	A <sub>1</sub> ①	B <sub>1</sub>	L <sub>1</sub> ①	A <sub>2</sub> ①	L <sub>2</sub> ②	D	H		
VLR 4 - 20	238	213	451	-	-	142	109	20	-
VLR 4 - 30	265	213	478	-	-	142	109	21	-
VLR 4 - 40	296	237	533	-	-	160	131	23	-
VLR 4 - 50	323	237	560	-	-	160	131	25	-
VLR 4 - 60	350	237	587	-	-	160	131	26	-
VLR 4 - 80/7	423	265	688	-	-	185	130	33	-
VLR 4 - 80	423	265	688	-	-	185	130	33	-
VLR 4 - 100	477	265	742	-	-	185	130	36	-
VLR 4 - 120	531	265	796	-	-	185	130	37	-
VLR 4 - 140	589	315	904	-	-	200	130	41	-
VLR 4 - 160	643	315	958	-	-	200	130	43	-
VLR 4 - 190	-	335	-	749	1084	200	140	-	61
VLR 4 - 220	-	335	-	830	1165	200	140	-	63
VLR 4 - 240	-	385	-	911	1298	260	185	-	87
VLR 4 - 260	-	385	-	965	1350	260	185	-	89

## VERTICAL MULTISTAGE CENTRIFUGAL PUMPS

**E**

The VLR 8's are vertical multistage centrifugal pumps with "in line" suction and delivery points directly connected to an electric motor. They are not self-priming.

### Design Features include:

Impellers, diffusers and outer pump chamber in AISI 304 stainless steel, shaft in AISI 431 stainless steel. Base and head casting are cast iron. Tungsten carbide mechanical seal. EPDM o rings. All 'A' versions are complete with 1½" oval counterflanges. All 'F' versions are DN40 round flanges, counterflanges are available upon request.

Liquid temperatures range from -15°C to +120°C

Maximum operating pressures:

Oval flanges 16 bar

DIN flanges 25 bar (maximum pumped liquid temperature 85°C)

21 bar (maximum pumped liquid temperature 120°C)

Maximum inlet pressures:

VLR 8-20 – VLR 8-30 = 6 Bar

VLR 8-40 – VLR 8-200 = 15 Bar

### Applications include:

Water supply, pressure increase systems, irrigation, high pressure washers, fire fighting systems, boiler supply and liquid transfers.

The VLR range is also available with stainless steel AISI 304 base – VLRI range.

The VLR range is also available made with AISI 316 stainless steel impellers, diffusers, shaft, outer liner and base – VLRX range.

Please contact our sales representatives for further information.



MODEL	Motor Power		VOLTAGE	Amp.	µF.	CODE	PRICE
	HP	KW					
VLR 8 - 20 A M	1	0,75	1 ~ 230 V	5,2	25	450-2102	
VLR 8 - 20 A T			3 ~ 230 ÷ 400 V	3,3-1,9		450-1002	
VLR 8 - 30 A M	1,5	1,1	1 ~ 230 V	8	35	450-2103	
VLR 8 - 30 A T			3 ~ 230 ÷ 400 V	4,3-2,5		450-1003	
VLR 8 - 40 A M	2	1,5	1 ~ 230 V	12	45	450-2104	
VLR 8 - 40 A T			3 ~ 230 ÷ 400 V	5,9-3,4		450-1004	
VLR 8 - 50 A T	3	2,2	3 ~ 230 ÷ 400 V	8,8-5,1		450-1005	
VLR 8 - 60 A T	3	2,2	3 ~ 230 ÷ 400 V	8,8-5,1		450-1006	
VLR 8 - 80 A T	4	3	3 ~ 230 ÷ 400 V	11,8-6,8		450-1008	
VLR 8 - 100 A T	5,5	4	3 ~ 400 ÷ 690 V	16,8-9,7		450-1110	
VLR 8 - 120 A T	5,5	4	3 ~ 400 ÷ 690 V	16,8-9,7		450-1112	
VLR 8 - 140 F T	7,5	5,5	3 ~ 400 ÷ 690 V	21,5-12,4		453-1114	
VLR 8 - 160 F T	7,5	5,5	3 ~ 400 ÷ 690 V	21,5-12,4		453-1116	
VLR 8 - 180 F T	10	7,5	3 ~ 400 ÷ 690 V	28-16,4		453-1118	
VLR 8 - 200 F T	10	7,5	3 ~ 400 ÷ 690 V	28-16,4		453-1120	

## VLR 8

1 Version with oval flanges  
VLR 8-20 - VLR 8-120

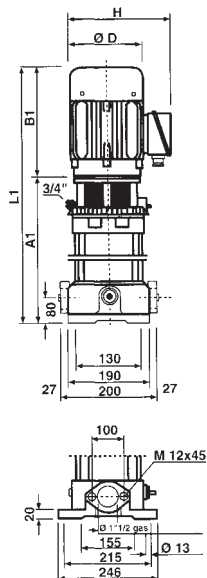

2 Version with round flanges  
PN25 DIN 2534/ISO 7005-2

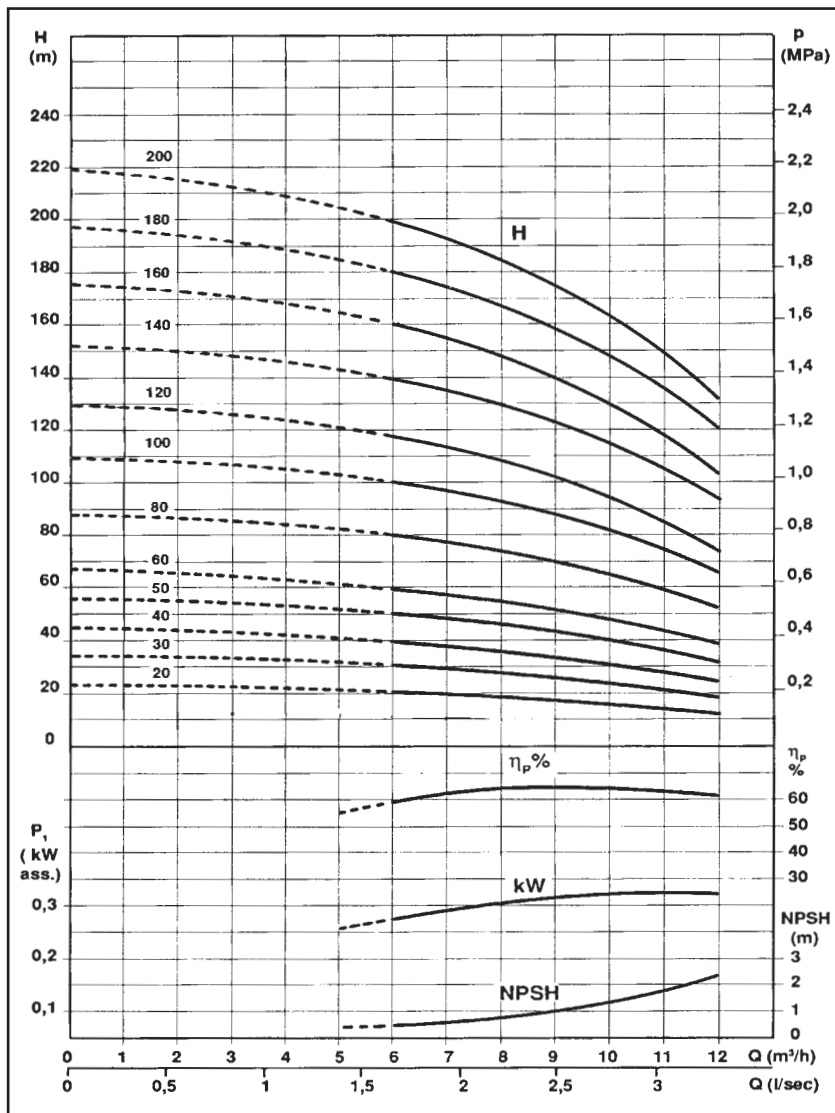
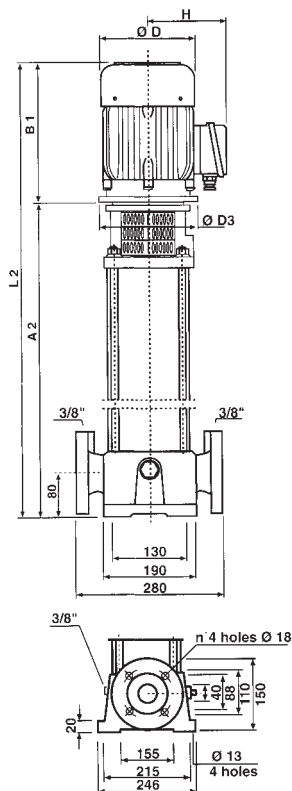

Model	Dimensions (mm)								Net Weight (kg)	
	A <sub>1</sub> ①	B <sub>1</sub>	L <sub>1</sub> ①	A <sub>2</sub> ②	L <sub>2</sub> ②	D	H	D <sub>3</sub>		
VLR 8 - 20	245	237	482	-	-	160	131	-	30	-
VLR 8 - 30	375	237	612	-	-	160	131	-	32	-
VLR 8 - 40	420	265	685	-	-	185	130	-	40	-
VLR 8 - 50	450	265	715	-	-	185	130	-	42	-
VLR 8 - 60	480	265	745	-	-	185	130	-	43	-
VLR 8 - 80	545	315	860	-	-	200	140	-	51	-
VLR 8 - 100	605	335	940	-	-	200	140	-	52	-
VLR 8 - 120	665	335	1000	-	-	200	140	-	56	-
VLR 8 - 140	-	385	-	745	1130	260	185	300	-	85
VLR 8 - 160	-	385	-	805	1190	260	185	300	-	86
VLR 8 - 180	-	385	-	865	1250	260	185	300	-	90
VLR 8 - 200	-	385	-	925	1310	260	185	300	-	91

## VERTICAL MULTISTAGE CENTRIFUGAL PUMPS

**E**

The VLR 16's are vertical multistage centrifugal pumps with "in line" suction and delivery points directly connected to an electric motor. They are not self-priming.

### Design Features include:

Impellers, diffusers and outer pump chamber in AISI 304 stainless steel, shaft in AISI 316 stainless steel. Base and head casting are cast iron. Tungsten carbide mechanical seal. EPDM o rings. These versions are with flanges DN 50 PN 25 DIN 2534/ISO 7005-2 (with 65mm diameter bore).

Counter flanges are available upon request – weldable DN 50 PN25  
– 2" threaded

Liquid temperatures range from -15°C to +120°C

Maximum operating pressures:

Maximum inlet pressures:

VLR 16-30/2 – VLR 16-18 = 16 Bar

VLR 16-100 – VLR 16-160 = 25 Bar (maximum pumped liquid temperature 85°C)

VLR 16-100 – VLR 16-160 = 23 Bar (maximum pumped liquid temperature 120°C)

Maximum inlet pressures:

VLR 16-30/2 – VLR 16-30 = 6 Bar

VLR 16-40 – VLR 16-100 = 15 Bar

### Applications include:

Water supply, pressure increase systems, irrigation, high pressure washers, fire fighting systems, boiler supply and liquid transfers.

The VLR range is also available with stainless steel AISI 304 base – VLRI range.

The VLR range is also available made with AISI 316 stainless steel impellers, diffusers, shaft, outer liner and base – VLRX range.

Please contact our sales representatives for further information.



MODEL	Motor Power		VOLTAGE	Amp.	CODE	PRICE
	HP	KW				
VLR 16 - 30/2 F T	3	2,2	3 ~ 230 ÷ 400 V	8,8-5,1	550-1002	
VLR 16 - 30 F T	4	3	3 ~ 230 ÷ 400 V	11,8-6,8	550-1003	
VLR 16 - 40 F T	5,5	4	3 ~ 400 ÷ 690 V	16,8-9,7	550-1104	
VLR 16 - 50 F T	7,5	5,5	3 ~ 400 ÷ 690 V	21,5-12,4	550-1105	
VLR 16 - 60 F T	7,5	5,5	3 ~ 400 ÷ 690 V	21,5-12,4	550-1106	
VLR 16 - 70 F T	10	7,5	3 ~ 400 ÷ 690 V	28-16,4	550-1107	
VLR 16 - 80 F T	10	7,5	3 ~ 400 ÷ 690 V	28-16,4	550-1108	
VLR 16 - 100 F T	15	11	3 ~ 400 ÷ 690 V	40-23,5	550-1110	
VLR 16 - 120 F T	15	11	3 ~ 400 ÷ 690 V	40-23,5	550-1112	
VLR 16 - 140 F T	20	15	3 ~ 400 ÷ 690 V	50-29	550-1114	
VLR 16 - 160 F T	20	15	3 ~ 400 ÷ 690 V	50-29	550-1116	

# SURFACE MOUNTED PUMPS

## VLR 16

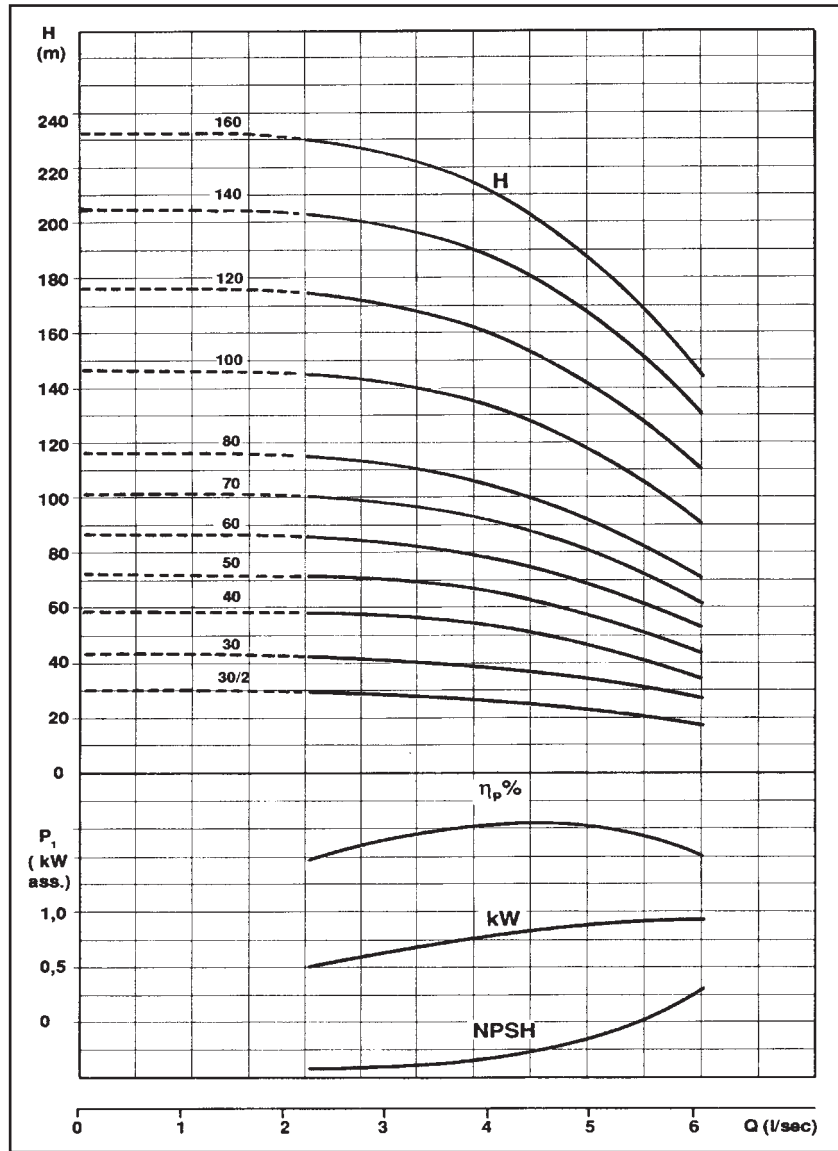
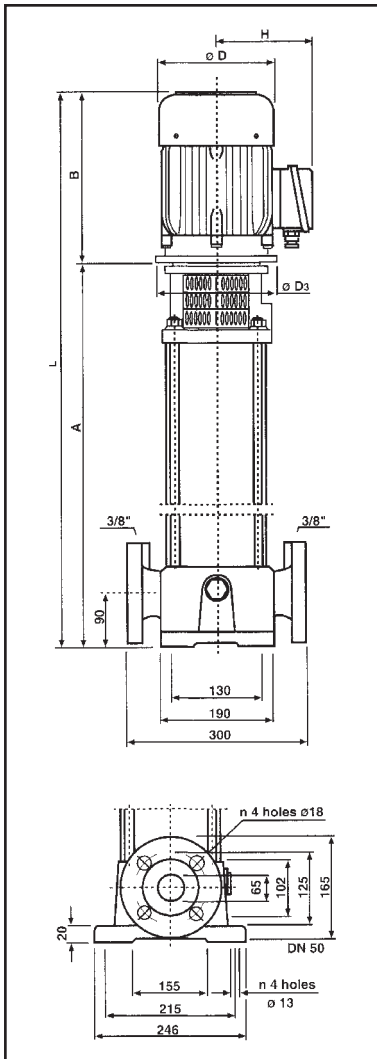

Model	Dimensions (mm)						Net Weight (kg)
	A	B	L	D	H	D <sub>2</sub>	
VLR 16 - 30/2	460	265	725	185	130	140	52
VLR 16 - 30	464	315	779	200	140	250	56
VLR 16 - 40	509	335	844	200	140	250	59
VLR 16 - 50	575	385	960	260	185	300	82
VLR 16 - 60	620	385	1005	260	185	300	84
VLR 16 - 70	665	385	1050	260	185	300	90
VLR 16 - 80	710	385	1095	260	185	300	92
VLR 16 - 100	830	495	1325	260	185	350	136
VLR 16 - 120	920	495	1425	260	185	350	140
VLR 16 - 140	1010	495	1505	310	230	350	181
VLR 16 - 160	1100	495	1595	310	230	350	185

## VERTICAL MULTISTAGE CENTRIFUGAL PUMPS

**E**

The VLR 32's are vertical multistage centrifugal pumps with "in line" suction and delivery points directly connected to an electric motor. They are not self-priming.

### Design Features include:

Impellers, diffusers and outer pump chamber in AISI 304 stainless steel, shaft in AISI 431 stainless steel. Base and head casting are cast iron. Tungsten carbide mechanical seal. EPDM o rings. These versions are flanged, complete with counter flanges.

Liquid temperatures range from -15°C to +120°C

Maximum operating pressures:

VLR 32-20 – VLR 32-60 = 16 Bar

VLR 32-70 – VLR 32-120 = 25 Bar (maximum pumped liquid temperature 85°C)

VLR 32-50 – VLR 32-160 = 23 Bar (maximum pumped liquid temperature 120°C)

Maximum inlet pressures:

VLR 32-10 = 3 Bar

VLR 32-20 – VLR 32-40 = 4 Bar

VLR 32-50 – VLR 32-90 = 10 Bar

VLR 32-110 – VLR 32-140 = 15 Bar

### Applications include:

Water supply, pressure increase systems, irrigation, high pressure washers, fire fighting systems, boiler supply and liquid transfers.



MODEL	Motor Power		VOLTAGE	Amp.	CODE	PRICE
	HP	KW				
VLR 32 – 10	3,00	2,20	3 ~ 230/400 V	8,6 5-5	660-0020	
VLR 32 – 20	5,50	4,00	3 ~ 400/690 V	8,6	660-0050	
VLR 32 – 30	7,50	5,50	3 ~ 400/690 V	11,3	660-0090	
VLR 32 – 40	10,00	7,50	3 ~ 400/690 V	14,7	660-0130	
VLR 32 – 50	15,00	11,00	3 ~ 400/690 V	21,0	660-0170	
VLR 32 – 60	15,00	11,00	3 ~ 400/690 V	21,0	660-0210	
VLR 32 – 70	20,00	15,00	3 ~ 400/690 V	29,0	660-0250	
VLR 32 – 80	20,00	15,00	3 ~ 400/690 V	29,0	660-0290	
VLR 32 – 90	20,00	15,00	3 ~ 400/690 V	29,0	660-0330	
VLR 32 – 100	25,00	18,50	3 ~ 400/690 V	35,0	660-0370	
VLR 32 – 110	25,00	18,50	3 ~ 400/690 V	35,0	660-0410	
VLR 32 – 120	30,00	22,00	3 ~ 400/690 V	42,0	660-0450	
VLR 32 – 130	40,00	30,00	3 ~ 400/690 V	55,0	660-0490	
VLR 32 – 140	40,00	30,00	3 ~ 400/690 V	55,0	660-0530	

## VLR 32

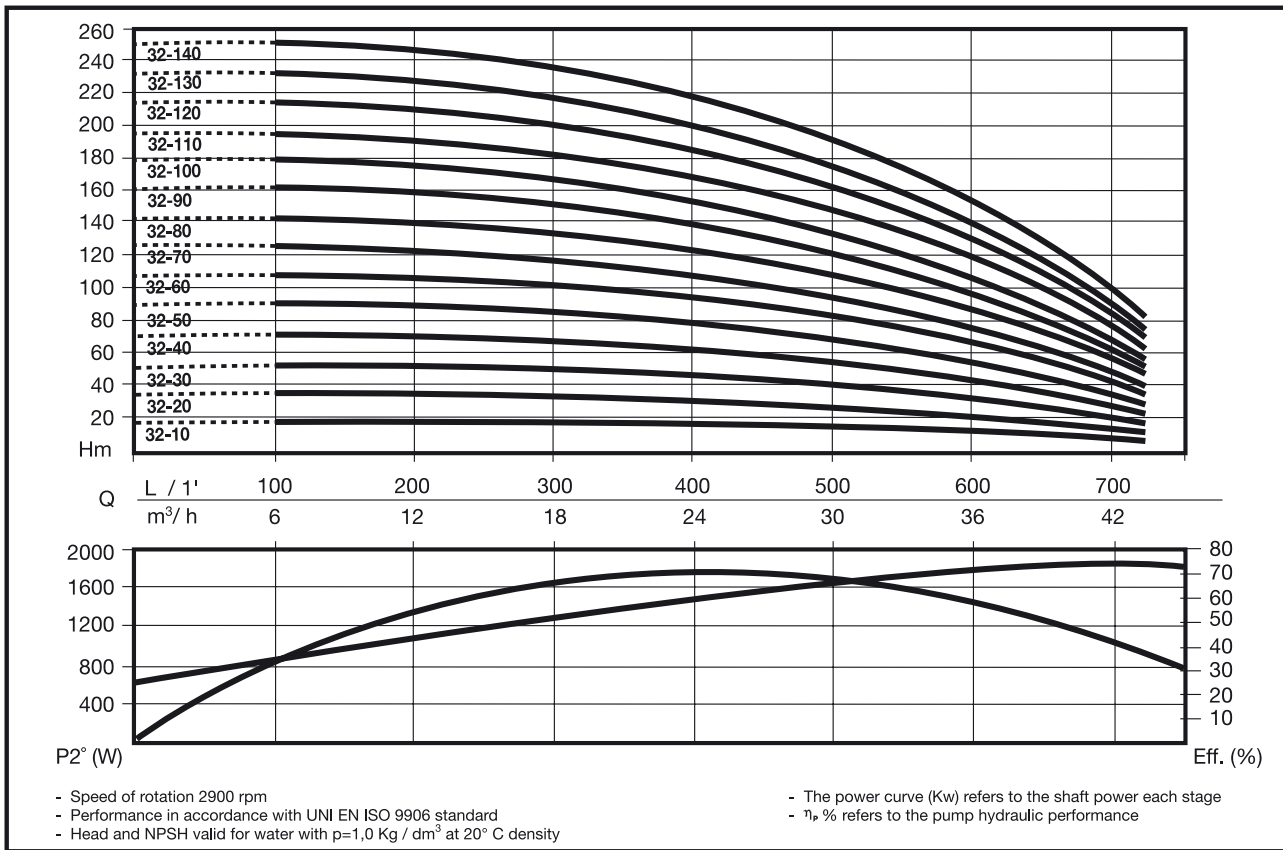

Model	Dimensions (mm)				Net Weight (kg)
	A	B	C	D	kg
VLR 32 - 10	580	850	185	145	78
VLR 32 - 20	650	950	210	155	93.5
VLR 32 - 30	770	1160	260	200	114
VLR 32 - 40	840	1230	260	200	121
VLR 32 - 50	910	1370	260	215	153
VLR 32 - 60	980	1440	260	215	157.5
VLR 32 - 70	1050	1510	260	215	166.5
VLR 32 - 80	1120	1580	260	215	177.5
VLR 32 - 90	1190	1650	320	245	200
VLR 32 - 100	1260	1800	320	245	218
VLR 32 - 110	1330	1870	320	245	222.5
VLR 32 - 120	1400	1980	320	245	236
VLR 32 - 130	1480	2120	360	275	269
VLR 32 - 140	1550	2190	360	275	280

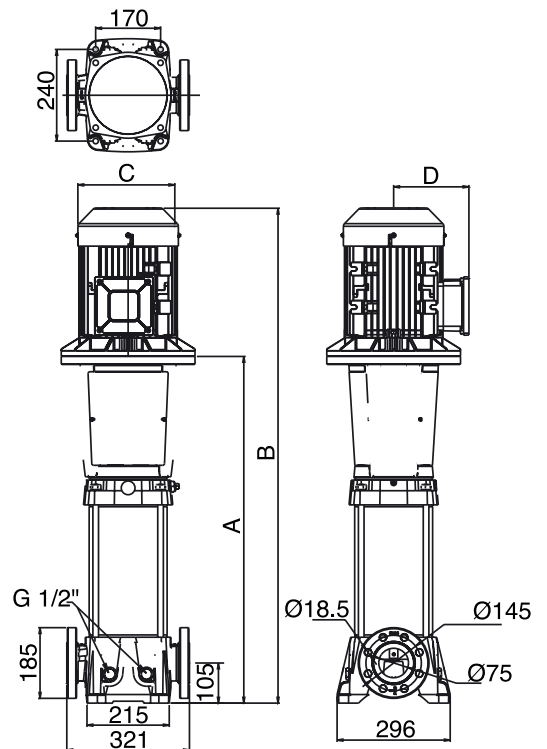

## VERTICAL MULTISTAGE CENTRIFUGAL PUMPS

**E**

The VLR 66's are vertical multistage centrifugal pumps with "in line" suction and delivery points directly connected to an electric motor. They are not self-priming.

**Design Features include:**

Impellers, diffusers and outer pumps chamber in AISI 304 stainless steel, shaft in AISI 431 stainless steel. Base and head casting are cast iron. Tungsten carbide mechanical seal. EPDM o rings. These versions are flanged. Counter flanges are not included.

Liquid temperatures range from -20°C to +120°C

Maximum operating pressures:

16 Bar including Suction head.

**Applications include:**

Water supply, pressure increase systems, irrigation, high pressure washers, fire fighting systems, boiler supply and liquid transfers.



VLR – shown as booster set application

MODEL	Motor Power		VOLTAGE	Amp.	CODE	PRICE
	HP	KW				
VLR 66 – 10 FT	7,50	5,50	3 ~ 400/690 V	11,3	760-0010	
VLR 66 – 20 FT	7,50	5,50	3 ~ 400/690 V	11,3	760-0020	
VLR 66 – 30 FT	10,00	7,50	3 ~ 400/690 V	14,7	760-0030	
VLR 66 – 40 FT	15,00	11,00	3 ~ 400/690 V	21,0	760-0040	
VLR 66 – 50 FT	20,00	15,00	3 ~ 400/690 V	29,0	760-0050	
VLR 66 – 60 FT	20,00	15,00	3 ~ 400/690 V	29,0	760-0060	
VLR 66 – 70 FT	25,00	18,50	3 ~ 400/690 V	35,0	760-0070	
VLR 66 – 80 FT	30,00	22,00	3 ~ 400/690 V	42,0	760-0080	

## VLR 66

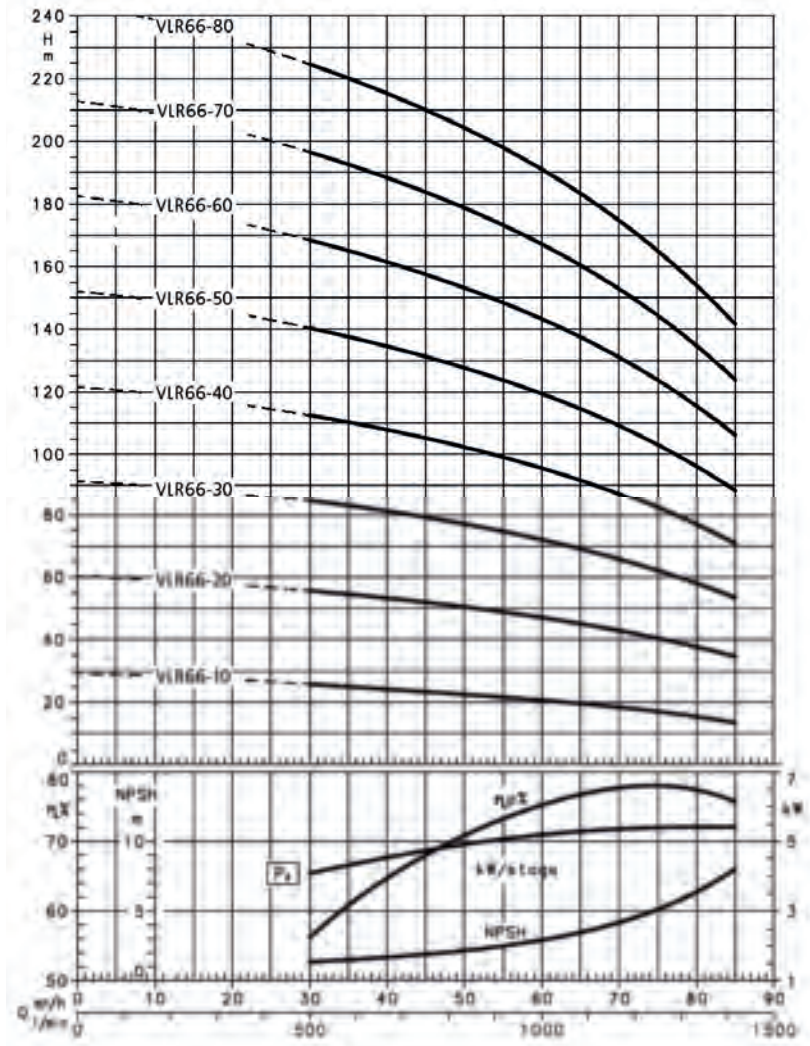

Performance in accordance with ISO 9906. Head and NPSH valid for  $\rho = 1,0 \text{ kg/dm}^3$  at  $20^\circ\text{C}$ . Power curve refers to shaft power per single stage.

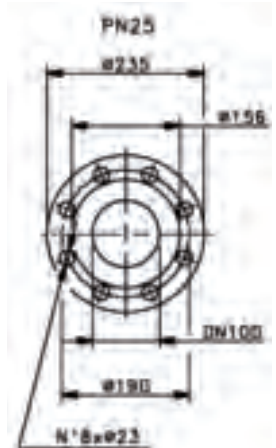
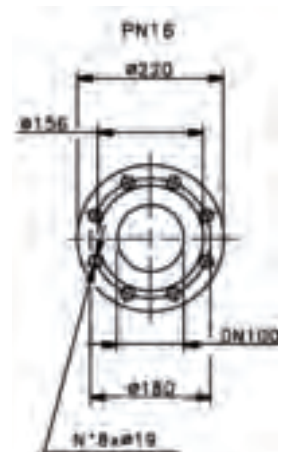
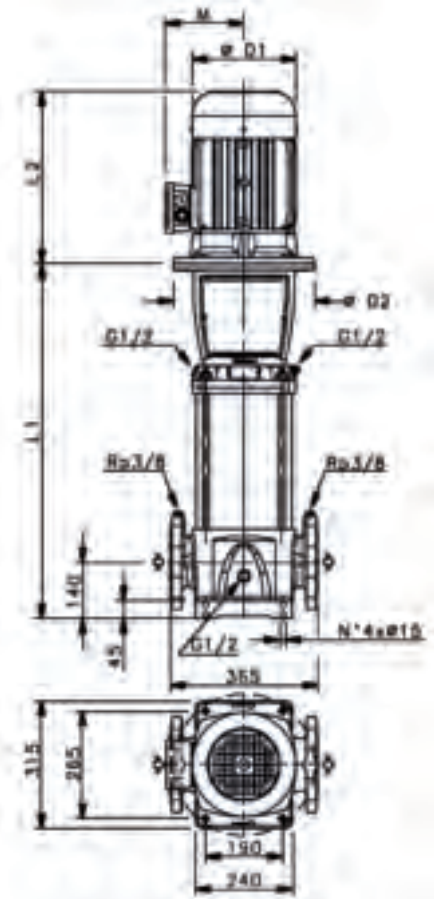

Model	Motor		Flange	Dimensions (mm)					Net Weight (kg)	
	kW	MEC		L <sub>1</sub>	L <sub>2</sub>	D <sub>1</sub>	D <sub>2</sub>	M	Pump-	Total
VLR 66 - 10	5,5	132	16	574	374	220	300	151	72	107
VLR 66 - 20	11	160	16	699	427	257	350	194	81	148
VLR 66 - 30	18,5	160	16	789	532	310	350	244	86	202
VLR 66 - 40	22	180	16	879	532	310	350	244	93	213
VLR 66 - 50	30	200	16	969	613	354	400	278	105	237
VLR 66 - 60	37	200	25	1059	613	354	400	278	113	255
VLR 66 - 70	45	225	25	1149	710	411	450	298	122	341
VLR 66 - 80	45	225	25	1239	710	411	450	298	127	346